

(1) (a) FIG. NO.	(2) (b) ITEM NO.	(3) SMR CODE	(4) NATIONAL STOCK NUMBER	(4) PART NUMBER	(5) FSCM	(6) DESCRIPTION USABLE ON CODE	(7) U/M	(8) INC IN UNIT
TM9-2320-209-20P								
0803-GEARSHIFT,VACUUM BOOSTER AND CONTROLS(CONT'D)								
100	18	PAOZZ	4730-00-952-7033	MS39189-1	96906	TEE,PIPE TO TUBE:HOSE AND SERVICE LINE AB,AC	EA	1
100	19	PAOZZ	4720-00-727-1627	8741776	19207	HOSE ASSEMBLY,RUBBER:AIR BRAKE AB,AC	EA	1
100	20	XBOZZ		10937722	19207	TUBE ASSEMBLY,METAL:AIR CONTROL VALVE TO FIREWALL AB,AC	EA	1
100	21	PAOZZ	4730-00-456-5938	10924754	19207	UNION,TUBE:FIREWALL AB,AC	EA	1
100	22	PAOZZ	4710-00-113-8048	10937717	19207	TUBE ASSEMBLY,METAL:74IN.LG, FIREWALL UNION TO FRAME CROSSMEMBER ELBOW AB,AC	EA	1
100	23	PAOZZ	5340-00-993-6207	MS21333-99	96906	CLAMP,LOOP AB,AC	EA	1
100	24	PAOZZ	4730-00-231-3960	MS20823-4	96906	ELBOW,PIPE TO TUBE:AIR CYLINDER SUPPLY AB,AC	EA	1
100	25	PAOZZ	5340-00-964-5267	MS21333-120	96906	CLAMP,LOOP:TUBE TO FRAME SIDE RAIL AB,AC	EA	1
100	26	PAOZZ	4720-00-771-5537	MS28741-4-0140	96906	HOSE ASSEMBLY:CROSSMEMBER ELBOW TO TRANSFER AIR CYLINDER AB,AC	EA	2
100	27	PAOZZ	5310-00-984-3807	MS51922-13	96906	NUT,SELF-LOCKING:ELBOW TO FRAME CROSSMEMBER AB,AC	EA	1
100	28	PAOZZ	4730-00-477-6244	10937866	19207	ELBOW,TUBE TO HOSE:FRAME CROSS-MEMBER MOUNTED AB,AC	EA	1
100	29	PAOZZ	4730-00-270-4580	MS39179-2	96906	ADAPTER,STRAIGHT,PIPE TO TUBE: AIR SUPPLY TUBE TO FRAME CROSS-MEMBER ELBOW AB,AC	EA	1
100	30	PAOZZ	4730-00-542-3284	7347982	19207	ADAPTER,STRAIGHT:FRAME CROSS-MEMBER ELBOW TO SUPPLY HOSE AB,AC	EA	1
100	31	PAOZZ	5306-00-225-9089	MS90726-34	96906	BOLT,MACHINE:ELBOW TO FRAME CROSS-MEMBER AB,AC	EA	2
101	1	MOOOO	2590-00-111-6661	11609240	19207	CABLE JUMPER ASSEMBLY:AIR PRES-SURE SWITCH TO INSTRUMENT FEED CONNECTOR AND AIR LOCK-UP INDICATOR LAMP ASSY	EA	1
101	2	PAOZZ	1015-00-798-2997	7982997	19207	TERMINAL	EA	3
101	3	PAOZZ	5970-00-833-8562	8338562	19207	INSULATOR,BUSHING	EA	3
101	4	PAOZZ	5935-00-677-4444	7064586	19207	INSERT,PLUG,ELECTRICAL	EA	1
101	5	PAOZZ	6145-00-772-0853	7720853	19207	CABLE,ELECTRICAL:NO.14,5IN.LG	EA	2
101	6	PAOZZ	5935-00-833-8561	8338561	19207	SHELL,ELECTRICAL CONNECTOR	EA	1
101	7	PAOZZ	5999-00-057-2929	MS27138-2	96906	CONTACT,ELECTRICAL	EA	1
101	8	PAOZZ	5310-00-833-8567	8338567	19207	WASHER,SLOTTED	EA	1
101	9	PAOZZ	5935-00-572-9180	8338566	19207	SHELL,ELECTRICAL CONNECTOR	EA	1

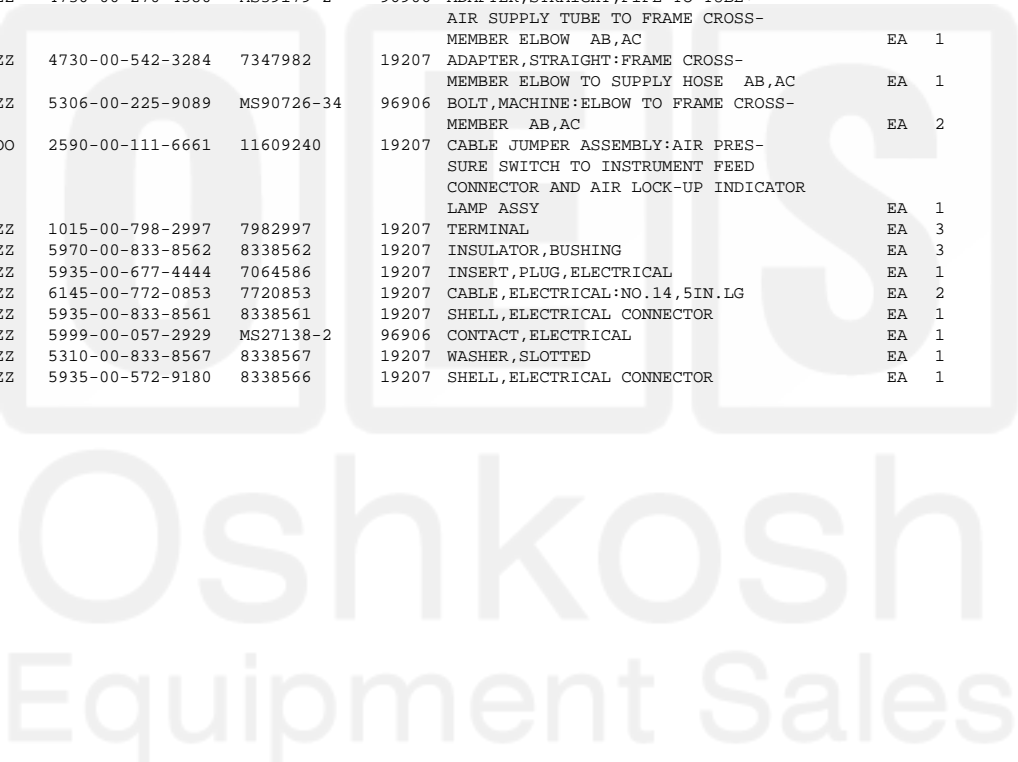

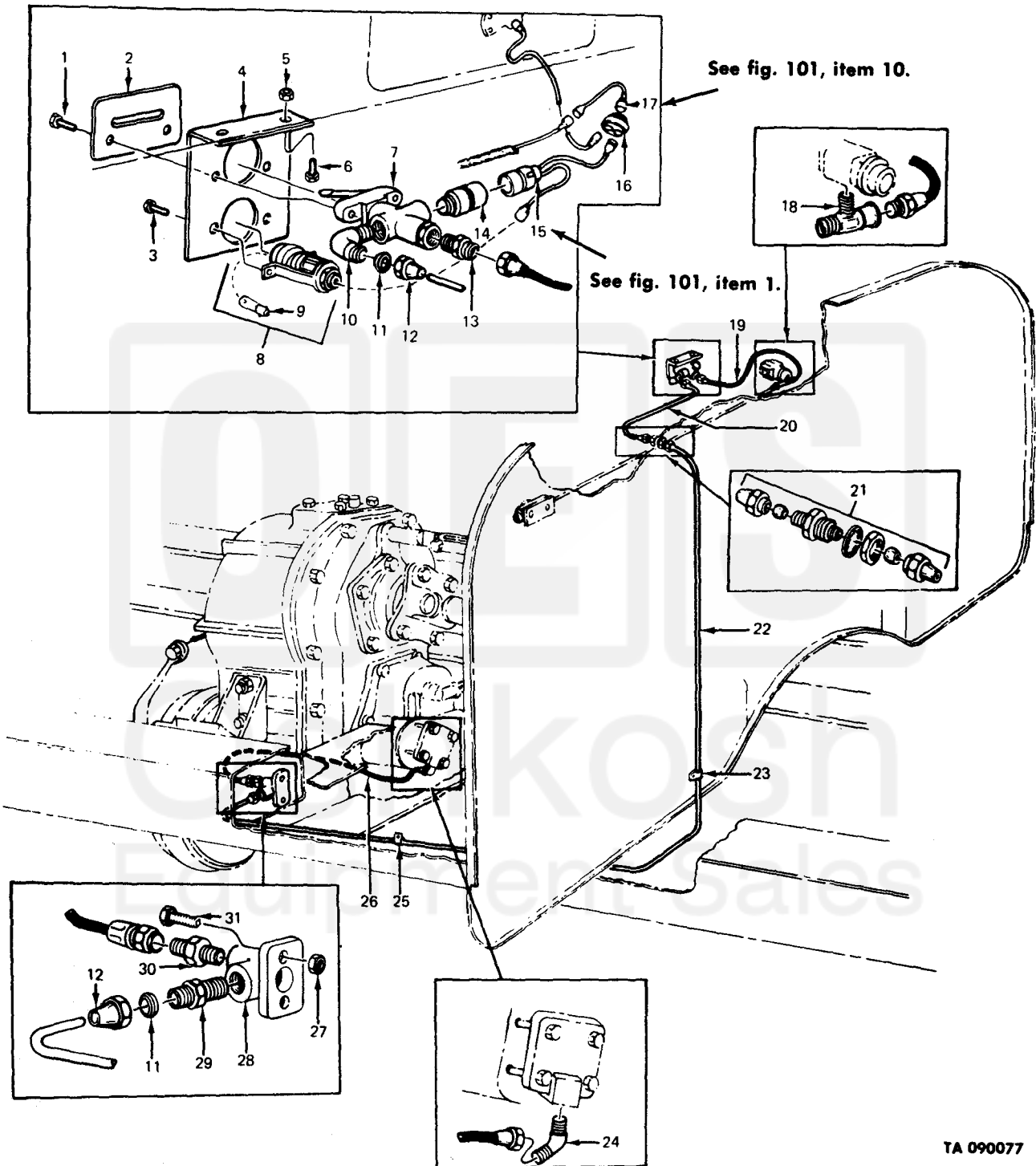

TA 090077

Figure 100. Sprag unit to air actuated lockup transfer conversion kit.

Current part is item (19,34,33) on diagram. Available at www.oshkoshequipment.com

(1) FIG. NO.	(2) ITEM NO.	(3) SMR CODE	(3) NATIONAL STOCK NUMBER	(4) PART NUMBER	(5) FSCM	(6) DESCRIPTION USABLE ON CODE	(7) U/M	(8) INC IN UNIT
TM9-2320-209-20P								
1208 - AIR BRAKE SYSTEM (CONT'D)								
121	34	PAOZZ	4720-00-727-1627	8741776	19207	HOSE ASSEMBLY,RUBBER:MANIFOLD TO AIR GAGE	EA	1
121	35	PAOZZ	5310-00-409-9914	5322923	19207	NUT	EA	1
121	36	PAOZZ	5310-00-582-6714	MS35333-49	96906	WASHER,LOCK	EA	1
121	37	PAOZZ	2530-00-133-8126	7529465	19207	FITTING,MANIFOLD	EA	1
121	38	PAOZZ	4730-00-069-1187	MS39182-3	96906	ELBOW,PIPE TO TUBE	EA	5
121	39	PAOZZ	4730-00-335-1776	7373380	19207	ELBOW,PIPE TO TUBE	EA	1
121	40	PAOZZ	4730-00-288-9491	MS39190-4	96906	TEE:RESERVOIR TO AIR LINES	EA	1
121	41	PAOZZ	4730-00-289-0051	MS39182-6	96906	ELBOW,PIPE TO TUBE	EA	1
121	42	XBOZZ		7061215	19207	TUBE:BOOSTER TO RESERVOIR (M36, M36C,M46,M46C,M292,M36A1, M46A1,M46A1C,M292A1)	EA	1
121	42	XBOZZ		7529416	19207	TUBE:BOOSTER TO RESERVOIR (M35,M109A1)	EA	1
121	42	XBOZZ		7368574	19207	TUBE:BOOSTER TO RESERVOIR (M49C, M49A1C,M50,M50A1)	EA	1
121	43	PAOZZ	5930-00-789-6192	11602160	19207	SWITCH PRESSURE:HYDRAULIC	EA	1
121	43.1	PAOZZ	4730-00-842-8336	444150	24617	TEE:PRESSURE SWITCH TO ELBOW	EA	1
121	43.2	PAOZZ	4730-00-289-0155	MS39182-5	96906	ELBOW:PRESSURE SWITCH TO TEE	EA	1
121	44	PAOZZ	4730-00-760-5879	8712201	19207	TEE ASSEMBLY:RESERVOIR TO BOOSTER CYLINDER LINE AT RESERVOIR	EA	1
121	45	MFOZZ	4710-00-177-8607	10897076	19207	TUBE:COMPRESSOR TO RESERVOIR,MFD FROM 4710-00-277-5529, 150 INCHES LONG	EA	1
121	46	PAOZZ	4730-00-289-0051	MS39182-6	96906	ELBOW,PIPE TO TUBE:BRAKE BOOSTER TO RESERVOIR TUBE	EA	1
122	1	PAOZZ	5310-00-959-1488	MS51922-21	96906	NUT,SELF-LOCKING	EA	8
122	2	PAOZZ	5305-00-269-2805	MS90726-62	96906	SCREW,CAP,HEXAGON HEAD (M36A2, M36A2C,M46A2,M46A2C,M292A2, M292A5)	EA	2
122	3	PAOZZ	5340-00-854-6730	MS21333-124	96906	CLAMP,LOOP:AIR BRAKE LINES	EA	1
122	4	PAOZZ	5340-00-337-9619	7373381	19207	CLAMP,LOOP	EA	3
122	5	XBOZZ		7061212	19207	TUBE:BOOSTER CYLINDER TO TRAILER AIR SERVICE BRAKE COUPLING ELBOW (M36A2,M36A2C,M46A2C,M292A2)	EA	1
122	5	XOBZZ		8757953	19207	TUBE:BOOSTER CYLINDER TO TRAILER AIR SERVICE BRAKE COUPLING ELBOW 9M46A2,M292A5)	EA	1
122	5	XBOZZ		7529417	19207	TUBE:BOOSTER CYLINDER TO TRAILER AIR SERVICE BRAKE COUPLING ELBOW (M35A2, M35A2C,M44A2,M45A2,M109A3, M185A3,M49A2C,M50A2,M50A3)	EA	1
122	6	PAOZZ	5305-00-269-2803	MS90726-60	96906	SCREW,CAP,HEXAGON HEAD	EA	7

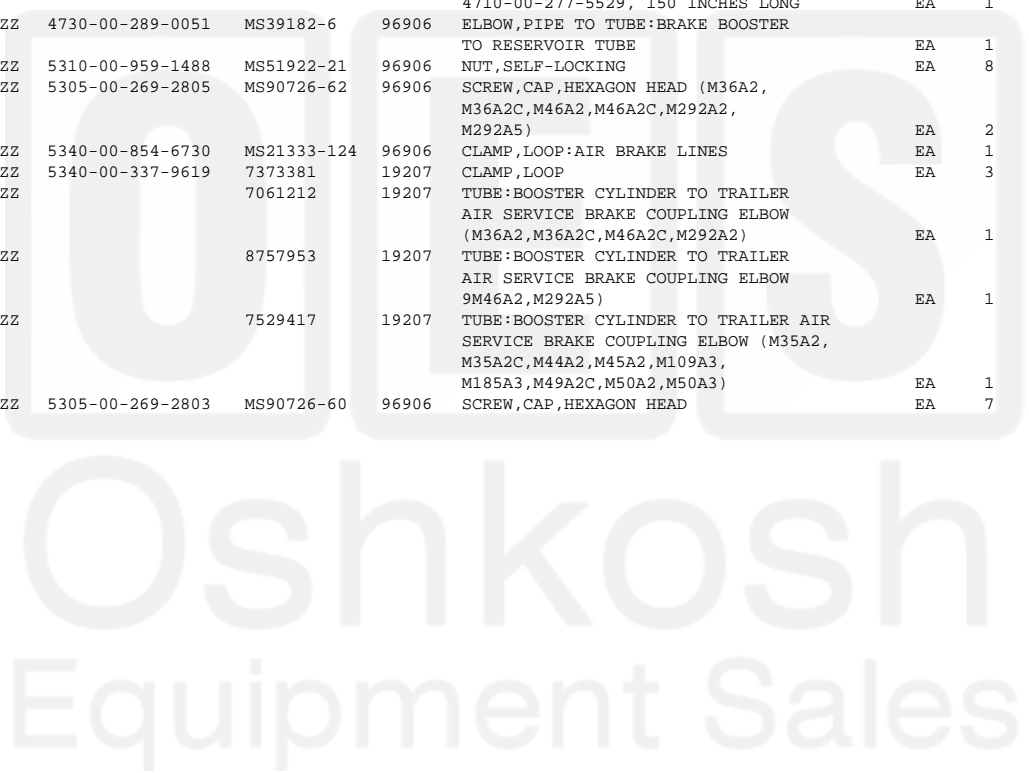

Current part is item (19,34,33) on diagram. Available at www.oshkoshequipment.com

Current part is item (19,34,33) on diagram. Available at www.oshkoshequipment.com

(1) (a) FIG. NO.	(2) (b) ITEM NO.	(3) SMR CODE	(4) NATIONAL STOCK NUMBER	(5) PART NUMBER	(6) DESCRIPTION FSCM	(7) U/M	(8) INC IN UNIT
TM9-2320-209-20P							
1208 - AIR BRAKE SYSTEM (CONT'D)							
122	25	PAOZZ	4730-00-782-5461	MS39190-2	96906 TEE,PIPE TO TUBE	EA	1
122	26	PAOZZ	4730-00-494-6580	MS39190-3	96906 TEE	EA	1
122	27	XBOZZ		10871564	19207 TUBE	EA	1
122	28	PAOZZ	5310-00-959-7600	MS51922-5	96906 NUT,SELF-LOCKING:AIR SUPPLY VALVE	EA	2
122	29	PAOZZ	5305-00-267-8974	MS90726-8	96906 SCREW,CAP,HEXAGON HEAD	EA	2
122	30	PAOZZ	2530-00-753-3853	MS500046-1	96906 VALVE:AIR SUPPLY ASSEMBLY	EA	1
122	31	PAOZZ	4730-00-069-1186	MS39179-5	96906 ADAPTER,STRAIGHT,PIPE TO TUBE: AIR SUPPLY VALVE TUBE	EA	1
122	32	PAOZZ	4730-00-221-2137	MS20913-2S	96906 PLUG,PIPE	EA	1
122	33	PAOZZ	4720-00-727-1627	8741776	19207 HOSE ASSEMBLY,RUBBER:ASSEMBLY MANIFOLD TO AIR GAGE,TO TRANSMISSION SWITCH TO PRESSURE GAGE	EA	2
122	34	PAOZZ	4730-00-640-6582	443977	21450 NIPPLE,PIPE	EA	1
122	35	XBOZZ		10871675	19207 TUBE:MANIFOLD TO WIPER VALVE	EA	1
122	36	PAOZZ	4730-00-142-3075	MS39179-4	96906 ADAPTER,STRAIGHT,PIPE TO TUBE	EA	1
122	37	PAOZZ	5306-00-018-6493	186493	21450 BOLT,ASSEMBLED WASHER	EA	1
122	38	PAOZZ	5930-00-434-5441	11621847	19207 SWITCH,PRESSURE	EA	1
122	39	PAOZZ	4730-00-069-1187	MS39182-3	96906 ELBOW,PIPE TO TUBE	EA	3
122	40	PAOZZ	5310-00-409-9914	5322923	19207 NUT	EA	1
122	41	PAOZZ	5310-00-550-3714	MS35333-47	96906 WASHER,LOCK	EA	1
122	42	PAOZZ	2530-00-133-8126	7529465	19207 FITTING,MANIFOLD	EA	1
122	43	PAOZZ	4730-00-952-7033	MS39189-1	96906 TEE,PIPE TO TUBE	EA	1
122	44	PAOZZ	4730-00-221-2136	MS20913-1S	96906 PLUG,PIPE	EA	1
122	45	PAOZZ	4730-00-288-9491	MS39190-4	96906 TEE:AIR RESERVOIR TO LINES	EA	1
122	46	PAOZZ	4730-00-760-5879	8712201	19207 TEE ASSEMBLY	EA	1
122	47	PAOZZ	4730-00-289-0051	MS39182-6	96906 ELBOW,PIPE TO TUBE	EA	2
122	48	PAOZZ	5930-00-789-6192	11602160	19207 SWITCH,PREWSSURE:HYDRAULIC	EA	1
122	48.1	PAOZZ	4730-00-842-8336	444150	24617 TEE:PRESSURE SWITCH TO ELBOW	EA	1
122	48.2	PAOZZ	4730-00-289-0155	MS39182-5	96906 ELBOW:PRESSURE SWITCH TO TEE	EA	1
122	49	PAOZZ	4730-00-542-3284	7347982	19207 ADAPTER,STRAIGHT	EA	1
122	50	PAOZZ	5310-00-984-3807	MS51922-13	96906 NUT,SELF-LOCKING	EA	1
122	51	PAOZZ	5306-00-225-9089	MS90726-34	96906 BOLT,MACNINE	EA	1
122	52	PAOZZ	4730-00-477-6244	10937866	19207 ELBOW,TUBE TO HOSE	EA	1
122	53	PAOZZ	4730-00-270-4580	MS39179-2	96906 ADAPTER,STRAIGHT	EA	1



Current part is item (19,34,33) on diagram. Available at www.oshkoshequipment.com

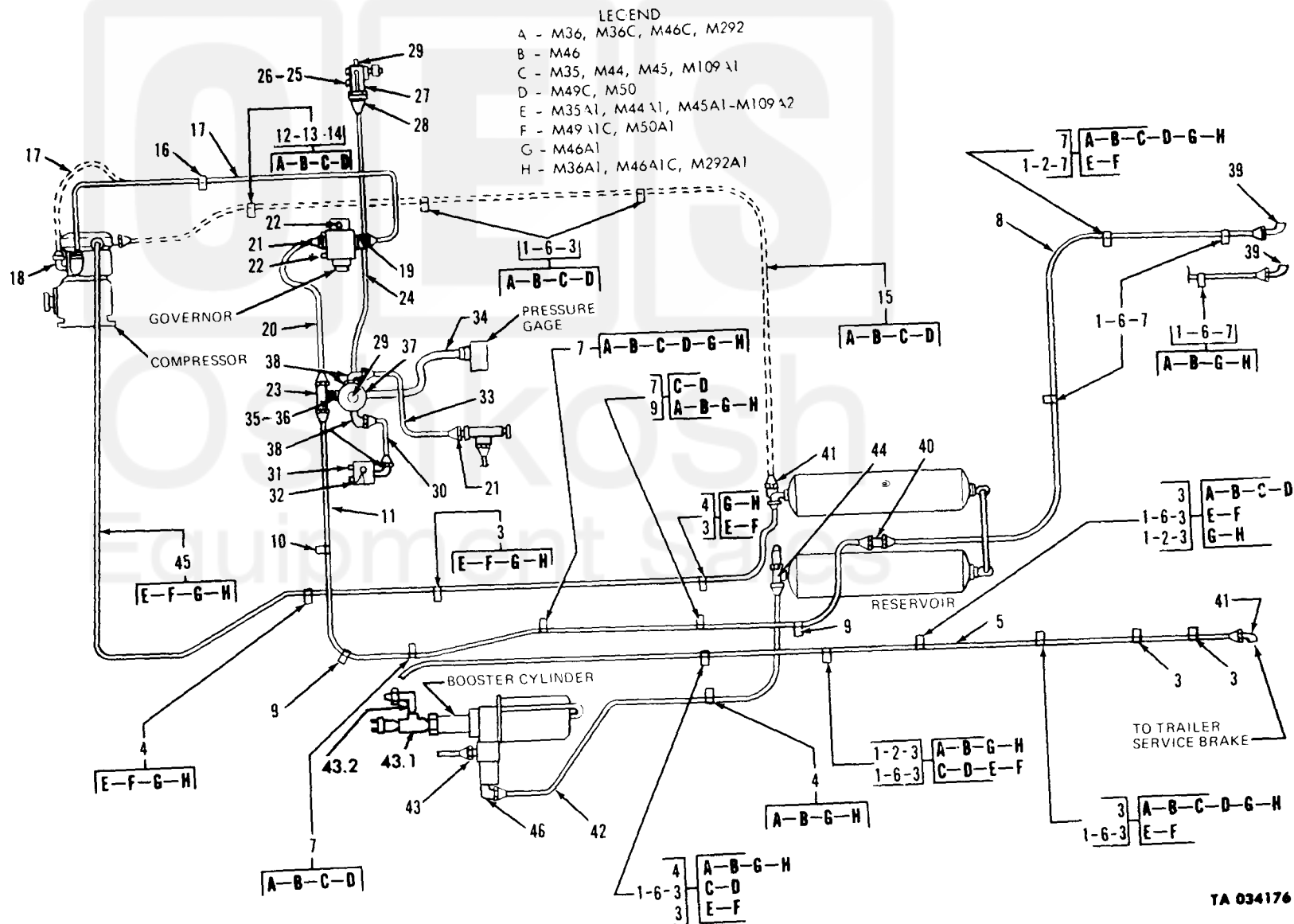

TA 034176

Change 1 275

TM 9-2320-209-20P

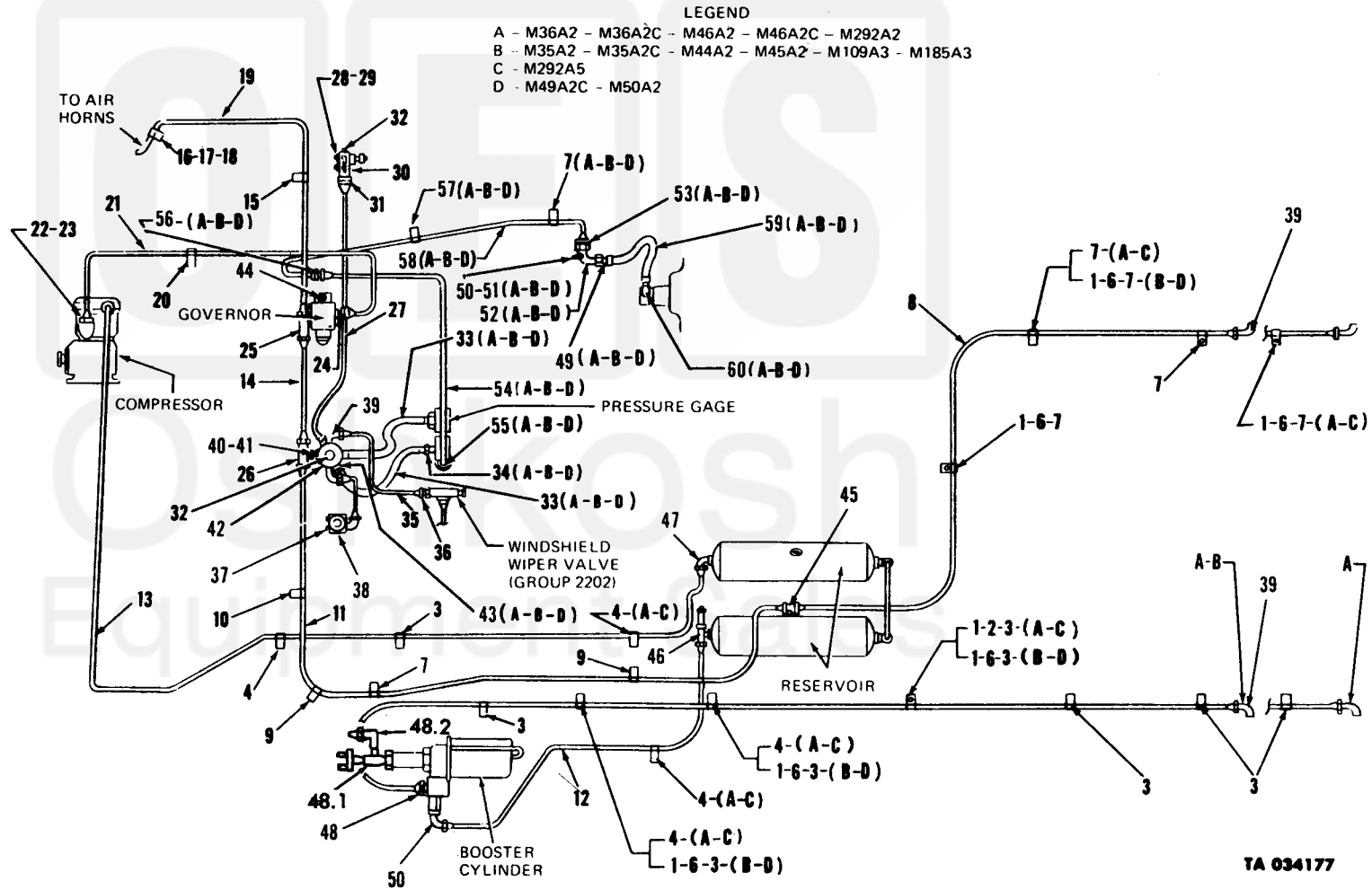

Figure 122. Airlines.